

**Family**  
COOKING EQUIPMENT STAR 90

**Section**  
GAS COOKERS

**Model**  
NC9FG8G36

**Code**  
CR0590090

#### 4-BURNER GAS RANGE WITH GAS OVEN

Range cooker with gas hob constructed from AISI 304 stainless steel. 20/10 pressed top, designed for flush alignment and to accommodate the water column accessory. Appliance comprises 4 sealed burners, 3 of which with maximum output of 6 kW and 1 with 10 kW. Safety tap with thermocouple for continuous output control from 1.6 to 6 kW and from 2.5 to 10 kW respectively. Main burner ignition by means of permanent, low-energy pilot burner (170 W). Pilot burner and thermocouple are located underneath the main burner body, protected from accidental impact and any spills. Hob features radiused corners for ease of cleaning and pan supports in RAAF enamelled cast-iron (acid, alkali and flame resistant). GN 2/1 gas oven with thermostatic control valve providing temperature adjustment from 50°C to 300°C. Burner with stabilized flame complete with pilot flame, safety thermocouple and piezoelectric ignition. Cooking chamber in stainless steel, dimensions 575x700x300h mm. Oven power 8 kW. Oven bottom in cast iron. Oven inner door in stainless steel with labyrinth seal. Appliance equipped with height adjustable feet in stainless steel. IPX5 protection rating.



#### Technical data

Width mm:	800	Internal dim. oven mm:	575x700x300h
Depth mm:	900	Oven capacity:	2 x GN 2/1
Height mm:	870	Oven power kW:	8 kW
Weight kg.:	147.00	Qty heating zones:	3 x 6 kW - 1 x 10 kW
Volume m <sup>3</sup> :	0.90	Plate dim. mm:	
Power supply:		Dim. heating zone mm:	
Gas power kW:	36.00	Qty tank:	
Electric power kW:		Tank dim. mm:	
		Tank capacity l:	

**Family**  
COOKING EQUIPMENT STAR 90

**Section**  
GAS COOKERS

**Model**  
NC9FG8G36

**Code**  
CR0590090

**4-BURNER GAS RANGE WITH GAS OVEN**

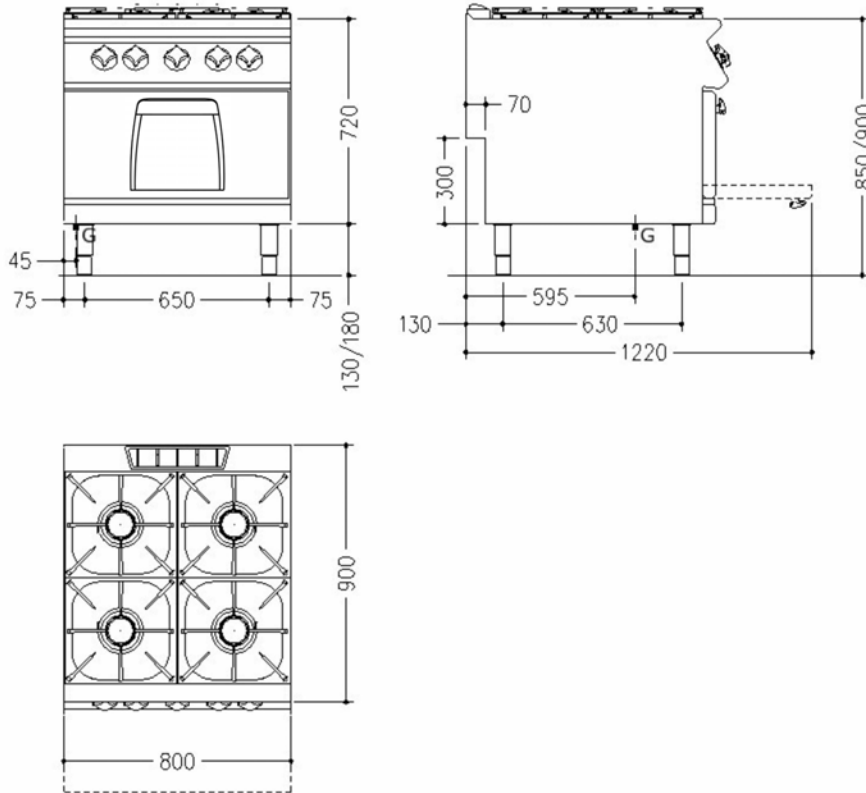

**Legend**

(E) Socket 1:

(E) Socket 2:

(G) Gas: Ø1/2"- H=200mm

(AD) Softened water:

(AF) Cold water:

(AC) Hot water:

(S) Draining:

(FR) In e out freon:

(V) Steam: