

Family
COOKING EQUIPMENT STAR 90

Section
GAS COOKERS ELECTRIC OVEN

Model
NC9FEV8G28

Code
CR1200810

4-BURNER GAS RANGE WITH ELECTRIC FAN OVEN

Range cooker with gas hob constructed from AISI 304 stainless steel. 20/10 pressed top, designed for flush alignment and to accommodate the water column accessory. Appliance comprises 4 sealed burners, 3 of which with maximum output of 6 kW and 1 with 10 kW. Safety tap with thermocouple for continuous output control from 1.6 to 6 kW and from 2.5 to 10 kW respectively. Main burner ignition by means of permanent, low-energy pilot burner (170 W). Pilot burner and thermocouple are located underneath the main burner body, protected from accidental impact and any spills. Hob features radiused corners for ease of cleaning and pan supports in RAAF enamelled cast-iron (acid, alkali and flame resistant). GN 2/1 conventional electric fan oven. Oven heated by independently controlled top and bottom heating elements. Thermostat control providing temperature adjustment from 110°C to 280°C. Cooking chamber in stainless steel, dimensions 575x700x300h mm. Oven bottom in cast iron. Oven inner door in stainless steel with labyrinth seal. 4-position selector switch, safety thermostat. Indicator leds indicating correct oven operation. Oven power: 6 kW. Appliance equipped with height adjustable feet in stainless steel. IPX5 protection rating.



Technical data

Width mm:	800	Internal dim. oven mm:	575x700x300h
Depth mm:	900	Oven capacity:	2 x GN 2/1
Height mm:	870	Oven power kW:	6 kW
Weight kg.:	145.00	Qty heating zones:	3 x 6 kW - 1 x 10 kW
Volume m ³ :	1.00	Plate dim. mm:	
Power supply:	VAC400 3N 50Hz	Dim. heating zone mm:	
Gas power kW:	28.00	Qty tank:	
Electric power kW:	6.08	Tank dim. mm:	
		Tank capacity l:	

Family
COOKING EQUIPMENT STAR 90

Section
GAS COOKERS ELECTRIC OVEN

Model
NC9FEV8G28

Code
CR1200810

4-BURNER GAS RANGE WITH ELECTRIC FAN OVEN

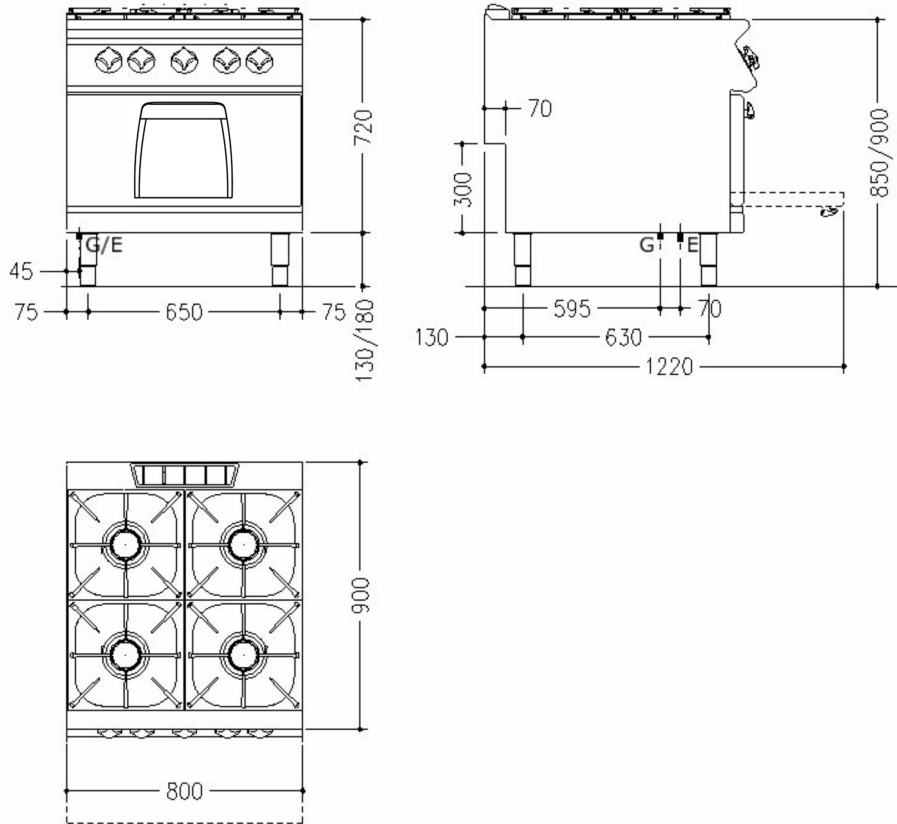

Legend

(E) Socket 1: Connection supply terminal floor level (+100mm). Spare cable 1500mm

(E) Socket 2:

(G) Gas: Ø1/2"- H=200mm

(AD) Softened water:

(AF) Cold water:

(AC) Hot water:

(S) Draining:

(FR) In e out freon:

(V) Steam: